

# Compriband-R3

Fast installation. Best quality.

**compriband**  
wir machen dicht!

**NEW**

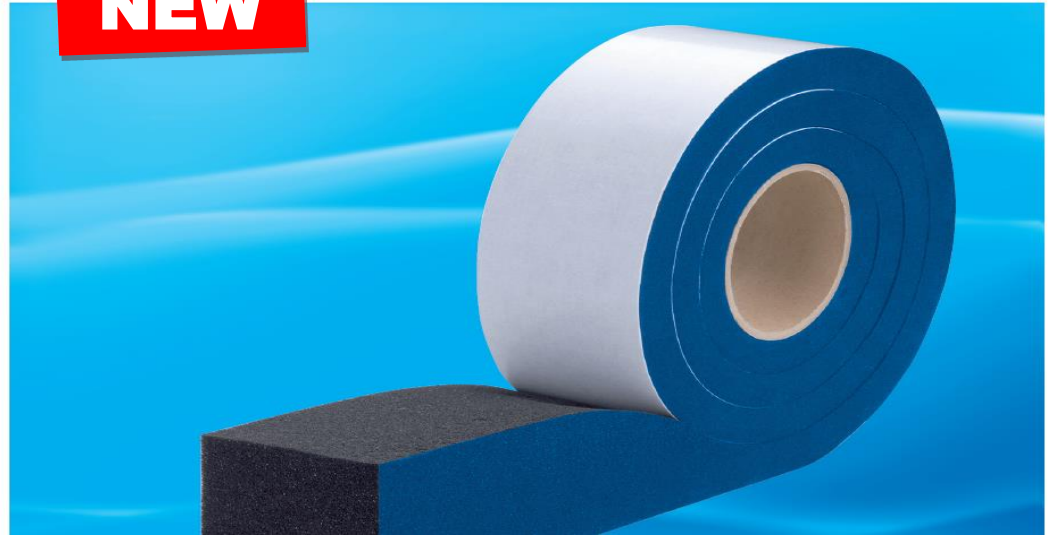
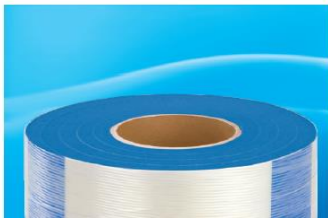
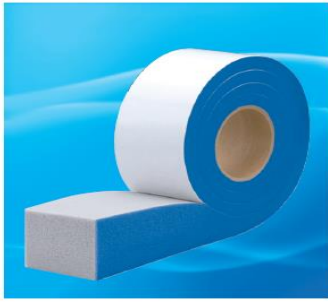

## Product information

One tape for all functional areas in the window-movement joint:  
Compriband-R3 is a special impregnated, pre-compressed multifunction tape which is consistent against air permeability. It is watertight against driving rain and is used for the insulation of window joints on the principle "inside tighter than outside".

Roomside/interior:	air tight according to DIN18542 BG R
Insulation level:	acoustic- and thermal-insulation
Weather side/outside:	consistent against wind and driving rain, vapor permeable

## Areas of Application

Compriband-R3 is a special impregnated, pre-compressed multifunction tape which is consistent against air permeability and watertight against driving rain. It is used for the insulation of window joints on the principle "inside tighter than outside". The side surface of the tape's inside is marked in colour to help distinguish the sides. This side must always look to the middle of the room.

## Examples of Application

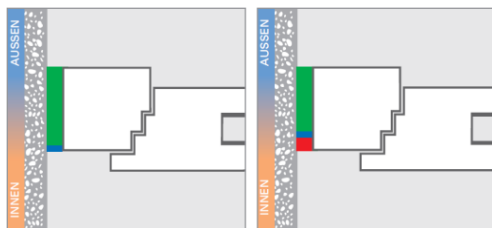

## Colour

- Grey and black (the inside is marked in colour).

## Product advantages

- Fast installation.
  - one sealing tape is sufficient.
  - no further operations.
- Consistent quality proofed by continuous external and internal supervision.
- Resistant against light and humidity according DIN 18542 BG1.
- Fire resistant according DIN 18542 BG1.
- Acoustic- and thermal-insulating.
- Very good noise reduction results (59 dB).
- Driving rain tight  $\geq 600$  Pa according DIN 18542 BG1
- Permanent joint dehydration.
- Compatible with conventional materials according DIN 18542 BG1.
- Adaption of any unevenness inside the joint and filling the remaining cavities.
- Paint coating compatible, tests necessary.
- Individual marking of the rolls with usability indication of each joint width.
- Shrinkwrapped tapes (to avoid dirt of the compressed roll).
- Solvent-free, no hazardous material.
- 10 years performance guarantee according to the manufacturer's conditions
- Storing Period: Approx. 1 year at room temperature, dry and originally packaged.

\* The properties and characteristics are depending on the compression of the tape. For application and installation-instruction please refer to separate instruction sheet.

## Delivery Form

- Pre-compressed rolls (see table with tape dimensions and roll lengths)

# Compriband-R3

Fast installation. Best quality.

**compriband**  
wir machen dicht!

## Technical Data<sup>1</sup>

(only valid for tapes with a maximum joint width of 20 mm)

Basis of foam	Polyurethane cellular foam	
Basis of impregnation	Acrylic resin with flame retardant	
<b>Properties</b>	<b>Classification</b>	<b>Norm</b>
Coefficient Of Drain Capacity	$a \leq 0,1$ [m <sup>3</sup> /(h.m.(daPa) <sup>0,5</sup> )]	DIN 18542 BGR
Watertight Against Driving Rain	$\geq 600$ Pa nach DIN 18542 BG 1	DIN EN 1027
Service Temperature	-30 °C to +90 °C	DIN 18542 BG 1
Compatibility with other building materials	Requirements met	DIN 18542 BG 1
Resistance to light and weather	Requirements met	DIN 18542
Building Classification/Flame Resistance	B1 (hardly inflammable)	DIN 4102
Classification	BG 1 und BGR	DIN 18542
Vapor pressure gradient	Open to diffusion on the outside (opposite side with coloring)	
Vapour diffusion resistance $\mu$	$\leq 100$	DIN EN ISO 12572
Long term durability	10 year functional guarantee <sup>3</sup>	
Storing Period	1 year at room temperature at 1 °C to 20 °C, in original packaging	

## Tape Dimensions/Delivery Form<sup>2</sup>

(further dimensions on request)

Dimension (mm)	Joint width (mm)	Tape Width/ Joint Depth (mm)	Roll length (m)	Box (m)
4-9x54	4-9	54	30	210
4-9x64	4-9	64	30	180
4-9x74	4-9	74	30	150
4-9x84	4-9	84	30	120
6-15x54	6-15	54	15	105
6-15x64	6-15	64	15	90
6-15x74	6-15	74	15	75
6-15x84	6-15	84	15	60
10-20x54	10-20	54	12	84
10-20x64	10-20	64	12	72
10-20x74	10-20	74	12	60
10-20x84	10-20	84	12	48

Further dimensions on request. Dimensional tolerances according to DIN 7715 P3.

## Application

**Tools:** For installation of the tapes get a measuring tape, knife / scissors and a spatula.

**Surface treatment of the joints:** Dirt, oil, fat, old sealing material and mortar residues have to be removed from the joint flanks.

**Determination of the dimensions of the tape:** Measure the window construction depth and the joint width (including tolerances and movement of the joint) and choose the correct dimension of the tape. In order to guarantee the required sealing effect of the installed tape, the prescribed areas of application (joint widths) of the individual tape dimensions may not be exceeded. The joint width has to be according to the dimensions of the tape (see table and price list). For tight joints, it is advantageous to moisten the tape.

**Preparation of the tape (the side marked in colour showing to the middle of the room):**

By cropping the tape please note the addition of at least 1 or 2 cm per meter. Cut off the piece of the beginning and the end of the roll. Remove the cover of the adhesive film and stick the pre-compressed tape on top of the clean and dry window frame. Start at the side of the frame with sticking up the tape on the bottom and then work upwards. Push the adhesive side tight against the component. It should be ensured that the tape is not elongated. As the tape changes its length after some time to the original length, light upsetting is advisable - otherwise leaks could arise. Press the tape at the upper frame against the horizontally bonded tape and stick out on each side along the tape the maximum of the joint width. The tape must not be applied in one piece around the frame. For safety reasons the tape must be laid offset at least 2 mm on both sides inwards from the leading edge of the joint.

**Rise-up-behavior:** Only the delayed decompression enables the installation. The expansion-behavior of the tape depends on the joint and the ambient temperature. At higher temperatures, the material returns relatively fast (the component must be installed quickly). Therefore storage >20°C should be avoided over a prolonged period (the tape should not be stored directly in the sun). At lower temperatures, we recommend to store the material at room temperature of about 20°C at least for 24 hours. The immediate expansion of the tape can be accelerated by heating with a hot air gun (in pivoting movements).

**Abutting points of the tape:** The individual tape lengths may be extended during the application by compressing the tailored tapes against each other. Joints or imperfections can be compensated with a suitable sealant

**Instructions:** The correct functioning of the tape can be achieved only under the condition if the tape is installed in accordance with our latest processing instructions, or has not applied and not been exposed to any unforeseeable influences for us. Decomposition caused by external effects is not covered by the warranty.

Decisive for the acceptance of a possible warranty claim: The professional processing by said standards and compliance with the processing instructions. Standing water or permanent water wetting cannot be permanently compensated by the product and is not a reason for complaint/claim. All commitments are relating to the use of the product at the Central European climate conditions. Before mounting read the manufacturer's processing instructions. If the manual is not available, contact the manufacturer or reseller. The technical data are subject to change with the degree of compression.

<sup>1</sup>The correct functioning of the tape can be achieved only under the condition if the tape is installed in accordance with our latest processing instructions, or has not applied and not been exposed to any unforeseeable influences for us. Decomposition caused by external effects is not covered by the warranty. Decisive for the acceptance of a possible warranty claim: The professional processing by said standards and compliance with the processing instructions. Standing water or permanent water wetting cannot be permanently compensated by the product and is not a reason for complaint/claim. All commitments are relating to the use of the product at the Central European climate conditions. Before mounting read the manufacturer's processing instructions. If the manual is not available, contact the manufacturer or reseller. The technical data are subject to change with the degree of compression.

<sup>2</sup>Component movements and temperature-dependent changes in length are to be added to the existing joint widths. Dimensional tolerance according to DIN 7715 P3.

<sup>3</sup>According to the manufacturer's conditions.